

DAMEN
/yachting

SeaXplorer 60



CONTENTS

01

Time to start your story



REACH THE DREAM

02

A yacht for all seasons



CUSTOM INSPIRATION

03

Luxury design inspiration



INTERIORS

04

Our proven fleet



SHOWCASES

05

Your configuration



SPECIFICATION AND BUILD

SEAXPLORER 60

We do things a bit differently. A luxury expedition yacht born from an innovative crossover of yachting and shipbuilding technology, the SeaXplorer is unlike any yacht on the market. To design a beautiful luxury yacht that also has real capability with professional safety and ocean-going seakeeping performance is an enormously challenging ambition.

That maverick thinking is part of our Damen DNA, it's the entrepreneurial spirit that led to our first Navy submarine, our first ice-breaking Coast Guard ship, our first Amels superyacht and many other innovations. Daring to be different has made us the diverse global shipbuilder that we are today. It's who we are. We can't help but be different. If you recognise that feeling, the SeaXplorer 60 is made for you.



Rose Damen
Managing Director

Rose Damen



Time to start
your story

01



REACH THE DREAM

Your SeaXplorer story begins here. The SeaXplorer 60 is a new development in our range of luxury expedition yachts built by Damen Yachting. Without you, she isn't complete. Your story, the experiences that have shaped your life – that's what lifts our technology to reach the pinnacle of expedition yacht design.



*The perfect marriage of
technology and luxury*

ADVENTURE SEEKER



SeaXplorer 60

- Length overall 60 metres (197 ft)
- Beam 11 metres (36 ft)
- Gross Tonnage approx. 1,160
- Total area approx. 1,850 square metres (20,000 sq ft)
- 6 suites for 12 guests

CROSSOVER LUXURY



Hybrid propulsion, battery electric power, and IMO Tier III engine emission technology.

The SeaXplorer began with a completely new approach by our team of maverick yacht builders. For our range of luxury expedition yachts, we combined our unique heritage – the quality and pedigree of almost 100 Amels superyachts, together with the best of Damen’s naval and offshore shipbuilding knowhow. Most of all, we’ve added the experience of our first three SeaExplorers delivered and the amazing feedback of our clients. The result of that development is our latest design, the SeaXplorer 60.



“I love to hear our clients’ powerful ideas for their own special SeaXplorer. Whether colours, finishing or completely unique configurations, our design philosophy is driven by the individual.”

Enrique Tintore - SeaXplorer Design Manager

WHAT MAKES A SEAXPLORER TRULY CAPABLE?

Compared to conventional yachts, the SeaXplorer fits a lot within her 60-metre length and generous 11-metre beam. Thanks to her large volume, with a Gross Tonnage of 1,160, she's self-sufficient for up to 30 days and carries a very impressive range of tenders and toys.

OUTSIDE DECK SPACE

Outdoor space for you to enjoy from the aft Swim Platform to the towering Crow's Nest.



TECHNICAL AND EXPEDITION STORAGE AREAS

Technical areas, engine room, audiovisual and air-conditioning spaces, as well as cool/dry stores for provisions.

SERVICE AND CREW QUARTERS

Service areas and pantries, galley, laundry, crew accommodation for up to 17 crew and expedition staff.

LUXURY INTERIORS

Luxury interiors over three guest decks, including six suites for 12 guests.

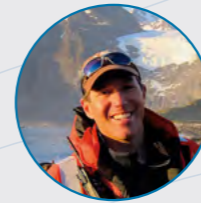

"The SeaXplorer is a luxurious oasis in the wilderness. It's not all luxury, because you need more than that here. It has comfort when you want it, capability when you need it."

Tim Soper - EYOS Expeditions

DEVELOPING THE SEAXPLORER

Practical shipbuilding with an adventurous spirit

Our in-house SeaXplorer design team developed our range of expedition yachts together with a top team of shipbuilding experts.

DESIGN PARTNER: AMELS

Our SeaXplorer team works closely with the naval architects and engineering specialists behind our renowned fleet of Amels yachts. The SeaXplorer includes our deep understanding of lifestyle design and luxury service for underway, at anchor and at the marina. Together we ensured the SeaXplorer makes no compromises on the superyacht experience.

DESIGN PARTNER: EYOS EXPEDITIONS

To understand not only the spirit of exploration but also its operational demands, we worked with EYOS Expeditions. After decades of designing once-in-a-lifetime experiences to our planet's most remarkable places, the EYOS experts know better than anyone how to organise bespoke superyacht expeditions in complete luxury and safety. They provided 150 SeaXplorer design items gained from hard-won experience in the field.

DESIGN PARTNER: AZURE YACHT DESIGN

We selected Azure Yacht Design, the highly experienced Dutch design and naval architecture studio, as our design partner for the SeaXplorer's exterior lines. Their unique and instantly recognisable philosophy is visible throughout the SeaXplorer range. The masculine and virile lines communicate the exceptional nature of the yacht as well as the deep heritage of Damen's shipbuilding.



EXTERIOR DESIGN

The SeaXplorer 60, the latest evolution in our proven SeaXplorer range, shares an award-winning design pedigree. With her luxuriously faired and perfectly finished beauty, she stands out in any yacht marina. The muscular and strong exterior lines come from our design partner Azure Yacht Design who, in close collaboration with the Owners, push the boundaries to create the ultimate yachting experience and exterior.



“With the SeaXplorer philosophy as the backbone of the exterior design, we focus on the yachting experience tailored to each Owner’s vision.”

Erik Spek - Director Azure Yacht Design



AWARD-WINNING EXTERIOR DESIGN

WINNER 2021 DESIGN & INNOVATION AWARDS

The SeaXplorer won the Boat International Judges' Commendation Award for exterior design thanks to the impressive impact of the styling from Azure Yacht Design. The judges cited her 'strong, inventive lines as creating an instantly identifiable, purpose-driven look'.



UNIQUE INTERIOR DESIGN

For the first SeaXplorer 60's luxury interiors, we asked H2 Design to create a brand new custom concept. H2 has developed custom concepts for our Amels clients, while the SeaXplorer 60 represents our first explorer yacht collaboration.



"The interiors apply a crisp design language with a rich, bold palette and a use of warm wood. It's comfortable, even casual. We wanted it to feel luxurious, without being heavy."

Jonny Horsfield - Director H2 Design

ABOUT H2 DESIGN

Director Jonny Horsfield established H2 Design in London in 1994. Since then the studio has developed an inviable reputation with a portfolio of more than 50 daring luxury yacht designs and large explorers delivered.

The Upper Deck Lounge and Dining looks out to spectacular views and the aft outdoor dining area.

VERSATILE MAIN DECK AFT

An exceptional feature on board the SeaXplorer 60, the Main Deck Aft below the helideck is a spacious 195 square-metre outdoor area (3,000 sq ft). The space is carefully designed for maximum flexibility – everything from carrying large tenders to outdoor entertaining.

FOR YOUR INSPIRATION

You can customise this space for each adventure you undertake. In our brochure, you'll find several proposals, including:

- Alfresco Cabana Lounge (pictured)
- Dive Deck
- Ski Lodge winter garden
- Gym and Wellness Zone

CABANA LOUNGE CONFIGURATION

Configured as a relaxed luxury cabana-style lounge and bar, the Main Deck Aft becomes a cool place to host your guests on warm evenings with gentle sea breezes.



A yacht for
all seasons

02



**DIVE INTO
ADVENTURE**

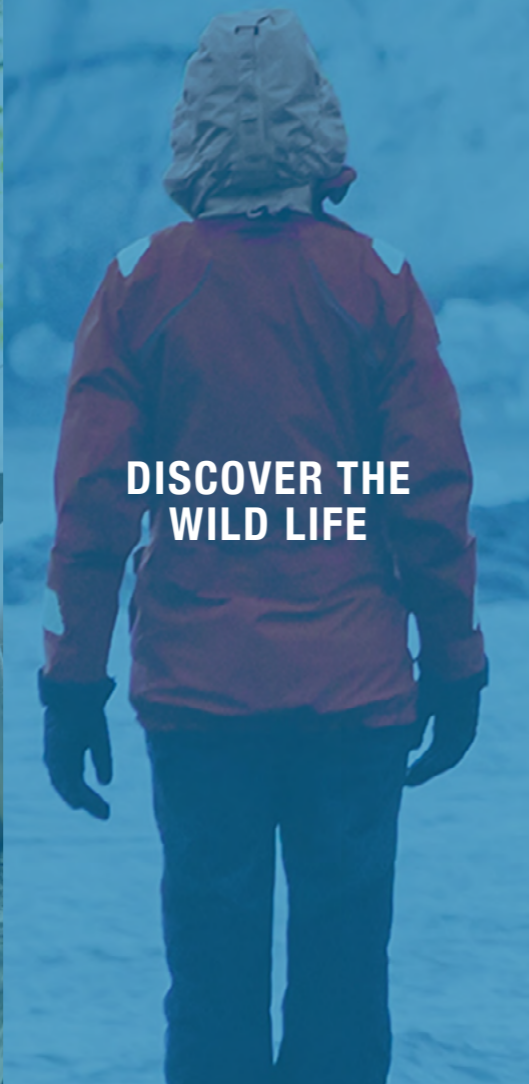

**DISCOVER THE
WILD LIFE**

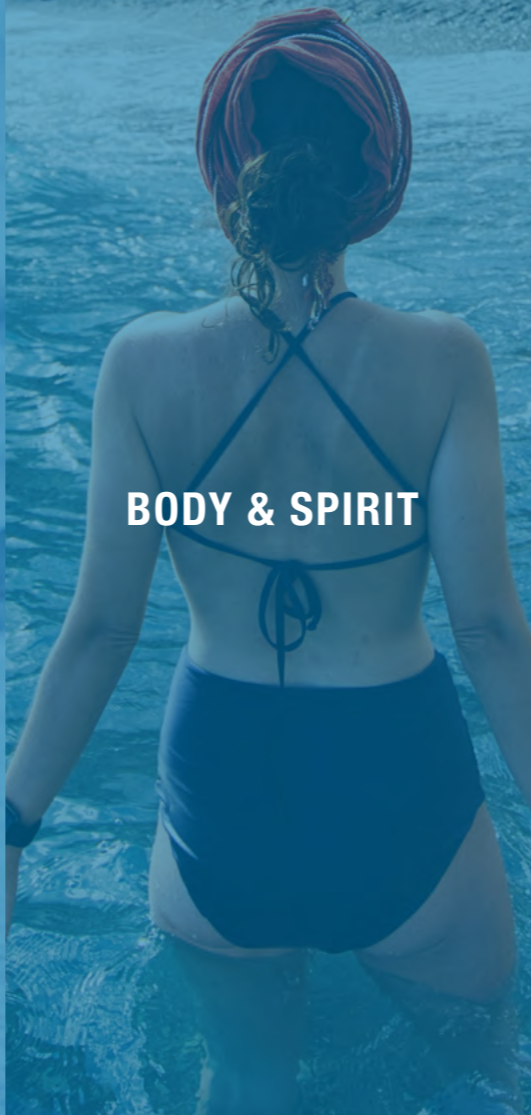

BODY & SPIRIT

CUSTOM INSPIRATION

Wherever in the world your adventures take you, we've designed the SeaXplorer 60 for versatile customisation. Get inspired with our ideas for configurations to match your mission. Spend a season in the tropics, exploring remote islands. Next season, head north to experience spectacular polar landscapes. And on the way, enjoy the Mediterranean's most glamorous coasts.



Underwater kingdoms

DIVE INTO ADVENTURE

When you imagine your own private map of Earth, which coasts, shorelines and underwater kingdoms have you yet to discover and share with your closest family and friends?





PRIVATE DESTINATIONS

The SeaXplorer 60 empowers you to reach new destinations away from the crowds, discover unknown natural marvels and historical treasures. Be the first to dive sites around the world. It's just you and your family and friends, plus a few colourful locals!



HYBRID POWER AND PROPULSION

- Electric drive motors supported by battery banks
- Quiet power generation, low vibrations and silent at anchor
- Less impact on the environment, contributing to more sustainable operations.
- Autonomous operations in zero-discharge zones such as marine nature reserves.

PARADISE FOUND

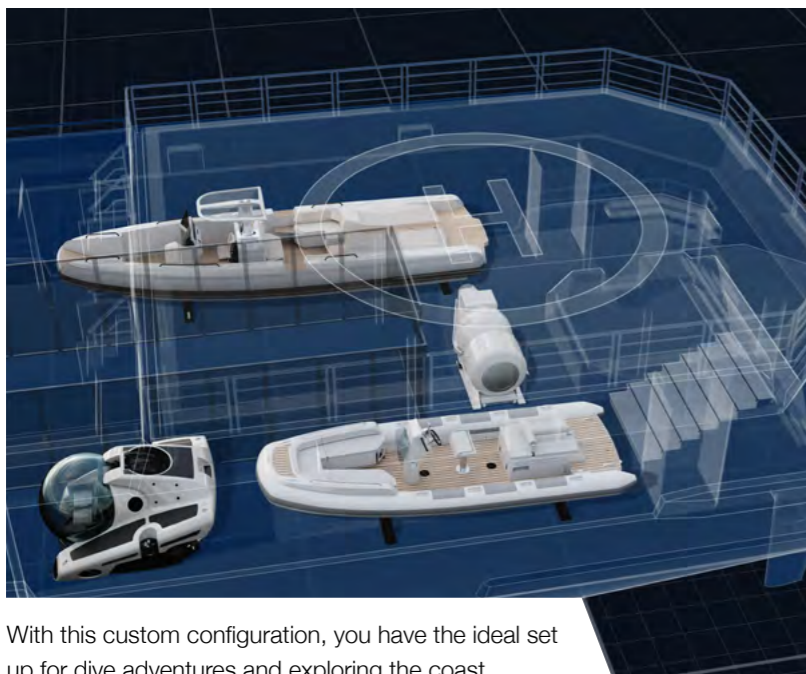

With this custom configuration, you have the ideal set up for dive adventures and exploring the coast.



Almost by definition, the world's most pristine places can only be accessed by sea. There are no airports, no roads, there's really no significant infrastructure of any kind. So you need the sea to get there. And when you get there, you need a platform to run the mission. You need the tools to make complex things happen in remote places – that's the underlying mission of any expedition yacht."

Rob McCallum - EYOS Expeditions

CONFIGURED FOR DIVE, SCIENCE AND COASTAL EXPLORATION

MAIN DECK

- Submersible eg U-Boat Worx C-Researcher 3 LH – 500
- 10.5-metre XTender expedition RIB (34 ft) beach lander with waterjet
- 7.5-metre XTender RIB (25 ft) that doubles as SOLAS rescue/crew tender
- Dive centre for scuba gear and tanks
- Decompression chamber for extra safety
- Storage rack for 500 litres petrol (132 gallons) in 25 jerry cans
- Sliding overhead cranes to deploy and retrieve equipment
- Boat whips port, starboard and on stern platform

LOWER DECK

- Cabins for extra dive crew, submersible pilots, scuba divemaster
- Wet lab
- Tech space for compressor, filling station, submersible maintenance, battery charging, camera rigging
- Workbench and parts storage

DIVE DECK

Configure your Main Deck Aft as a dive centre for briefings and relaxing between dives. The Dive Deck is also the space for evening BBQs while taking in the spectacular views.



- Wetsuit drying racks, stores for BCDs, regulators, fins, masks and more
- Tank racks, dive compressors and EANx (Nitrox) and trimix facilities
- 10.5-metre dive RIB (34 ft) to carry tanks and gear, as well as to move divers from site to site
- Helicopter and tender for guest transfers
- Accommodation for dive crew and guides, work stations for dive planning and video and image editing
- Underwater scooters (diver propulsion vehicles)
- Decompression chamber, hospital and remote diagnostics for emergency situations

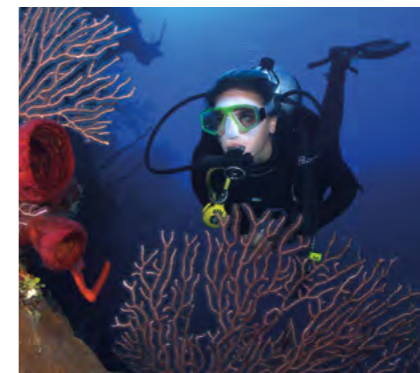



CONSERVATION AND EDUCATION

SWIM PLATFORM

- 22 square metres (237 sq ft)
- Transom door access to the multifunctional Lower Deck store
- Swim ladder or ask about integrated swim stairs



Create a custom ocean conservation Wet Lab in the multipurpose 40 square-metre Lower Deck store (430 sq ft). Make it your mission to research marine biology samples or contribute to seawater microalgae and plankton sampling. With a scientist on board, or your own team, you can change the way the world understands our oceans.

DISCOVERY WET LAB

- Workbench for microscopes, computer analysis, scales, dry and digital work
- Fume hood and bio hazard store, high-pressure gases, mix gases, oxygen, nitrogen
- Sample store, refrigerator, freezer and salt solution
- Multimedia editing

“Inspire a new generation while contributing to a better understanding and preservation of our ocean’s treasures.”



Safety in isolation

DISCOVER THE WILD LIFE

Heading to the polar zones doesn't need to mean leaving your comfort zone. SeaXplorer expedition yachting means taking the safety, reliability and performance you expect from your yacht right to the edges of the world.



SAFETY IN THE ICE

Explore the polar zones up close, reaching the most spectacular wildlife and landscapes – in complete safety, style and comfort.



- Ice Class hull for safety in quickly changing weather and ice conditions
- IMO Polar Code compliant standards for safety and environment (see page 54 for further details)
- Self-sufficient autonomy for up to 30 days without port call
- Sustainable operations for areas of fragile natural beauty
- Adjust your equipment list to match the mission – for example with sturdy Zodiac RIBs, the polar expedition workhorses





OBSERVATION LOUNGE

Watch the world go by in the 38 square-metre forward Observation Lounge (410 sq ft), where your exploration experiences come together in collected objects, books and multimedia. As the bright polar light pours inside through 270-degree panoramic views and large skylight, H2 Design's creates balance with darker moodier woods and a richly warm tone. A stunning lacquer ceiling dome merges into the skylight. Step outside to enjoy spectacular vantage points from the bow point observation deck.

OBSERVATION DECK AND CROW'S NEST

*Head to the Crow's Nest
on top of the world.*





SKY LOUNGE VISTAS



ALPINE SAUNA

Enjoy the alpine Spa vibe next to the day lounge in the cosy cocoon of the Bridge Deck sauna. The sauna is accentuated by glass doors to feel open, while soft woods, fibre optic lighting and stone walls lit from above make a warm and inviting interior.



Up on Bridge Deck, the aft-facing outdoor space can be fully enclosed with bifold doors to create a 33 square-metre Sky Lounge (355 sq ft) with skylight. With fabulous views, the inside-outside feeling is enhanced with the rippled ceiling effect reminiscent of reflections on water. H2 created a contemporary modern palette, with bold marble choices and reflective surfaces.



SKI LODGE

Configure your SeaXplorer for heliskiing, glacier trekking or snowmobile safaris.

On Main Deck Aft, a fully glass-enclosed 44 square-metre winter garden space (474 sq ft) provides the perfect place to collect your kit and enjoy an invigorating drink between heliski runs. Enjoy the panoramic views while you recount the exhilaration of the latest run.





FULLY CERTIFIED HELIDECK

For safe landings – night, day and underway in a wider weather window – the SeaXplorer has a certified helicopter landing area. Having a proper helideck also permits operations during charter and commercial use for more operational flexibility. See page 54 for more details on the technical standards required for certified helicopter landing areas.

HELIDECK STRENGTHENED FOR
MAXIMUM TAKE-OFF WEIGHT OF 4,000
KG AND D VALUE 13.

EXPEDITION LEADER

CONFIGURED FOR GETTING UP TO CLOSE TO SPECTACULAR WILDLIFE AND LANDSCAPES

- Helicopter eg ACH 135 twin-engine
- 8.5-metre custom Compass Landing Craft (28 ft) for transporting equipment, snowmobiles and more to shore
- 5.4-metre RIB (18 ft) with centre console, the expedition workhorse
- 5-metre rescue/crew tender (16 ft) with benches
- Snowmobiles eg Ski-Doo Grand Touring
- Helifuel station (Lower Deck)
 - Dedicated Jet A1 aviation fuel room with 3 cubic metre tank (660 US gallons)
 - Fuel pump skid, fuel re-cycling function to clean and prevent degradation of the helicopter fuel; EX space with dedicated fire extinguishing system
 - Fuel dispenser reels fitted under a hatch on the helideck
- Cabin for pilots and aviation engineer



CUSTOM CONFIGURATION

For frequent helicopter operations with autonomous operations farther afield, you may like to create a custom Lower Deck helifuel station.



FLIGHT CONTROL FOR SAFE LANDINGS

The SeaXplorer 60 supports your flight crew for safe landings. The pilot has a clear landing area with dedicated perimeter night landing lights and floodlights. The wheelhouse helicopter monitoring system includes precision meteorological/barometric data, motion sensor heave, ultrasonic anemometer, visibility and present weather sensor, cloud base sensor.

CUSTOM COLOUR SCHEME



Your individual choice of colour scheme, perfectly applied. We're happy to discuss your ideas for custom livery with you, such as this polar dazzle scheme created by exterior designer Azure Yacht Design.



Celebrate the ocean's rejuvenating power

BODY AND SPIRIT

Isn't that the luxury of life at sea? Where else can you enjoy the world's most glamorous coastlines, but also quiet contemplation far from the maddening crowds? With the SeaXplorer, you soak up the strength of the sea. Inspired, enlightened and rejuvenated.

BEAUTIFUL COAST



With the most fabulous views on board, fully open the bifold doors of the Sky Lounge to host intimate poolside gatherings by the bar. From here, the world opens up around you in splendid panorama.

After a full day enjoying the charms of local towns, your fully-electric 10.5-metre luxury tender (34 ft) such as Vita Power LION pictured, brings you back on board.



PRIVATE WHIRLPOOL

Behind the wheelhouse, high above sea level, the Sky Lounge opens up to a large whirlpool and sun loungers. Enjoy beautiful views from this private 115 square-metre (1,238 sq ft) indoor-outdoor space.



STAIRS TO BRIDGE DECK

You can access the Sky Lounge and wheelhouse either via the exterior port and starboard stairs, or from the Upper Deck guest corridor below.



The aft-facing Bridge Deck Sky Lounge with skylight has direct access to the wheelhouse guest area.

DINING AND ENTERTAINING

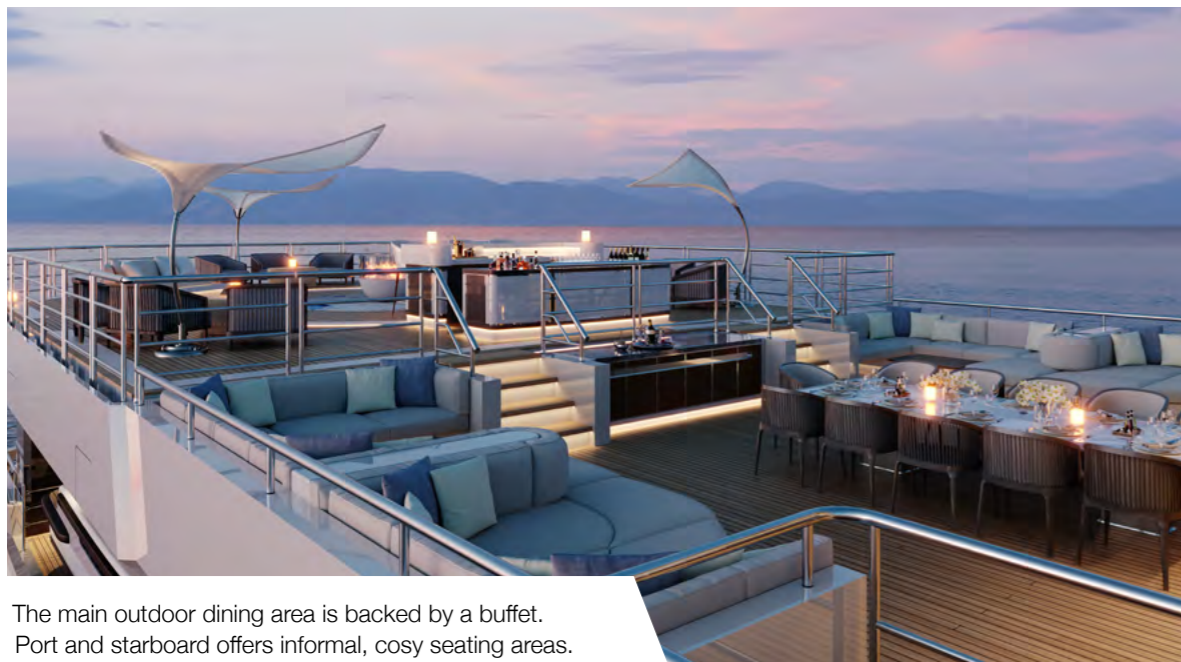

The main outdoor dining area is backed by a buffet. Port and starboard offers informal, cosy seating areas.



While not in use for helicopter operations, the huge aft deck offers the ideal platform for large gatherings and entertaining. The outdoor dining area with beautiful sea views leads up to a 150 square-metre bar and lounge area (1,615 sq ft).

For your inspiration, we've transformed the helideck into a 150 square-metre firepit lounge (1,615 sq ft) with bar. However, you could also create an outdoor cinema or party dancefloor on deck.

WATER SPORTS

Make the most of your time at sea with the most fun on the waves. Morning, noon and night, you'll never run out of ways to exercise your energy.

CONFIGURED FOR ACTIVE LIFESTYLES

- 10.5-metre Pasco limo tender (34 ft)
- 5.4-metre RIB tender (18 ft) with centre console
- 4 x 4.5-metre Laser XD (15 ft) performance racing class sailboats
- 2 x sea kayaks
- Basketball half-court
- Fitness and wellness centre
- 4 x gravel bikes (Lower Deck)
- Wake and surf board racks (Lower Deck)

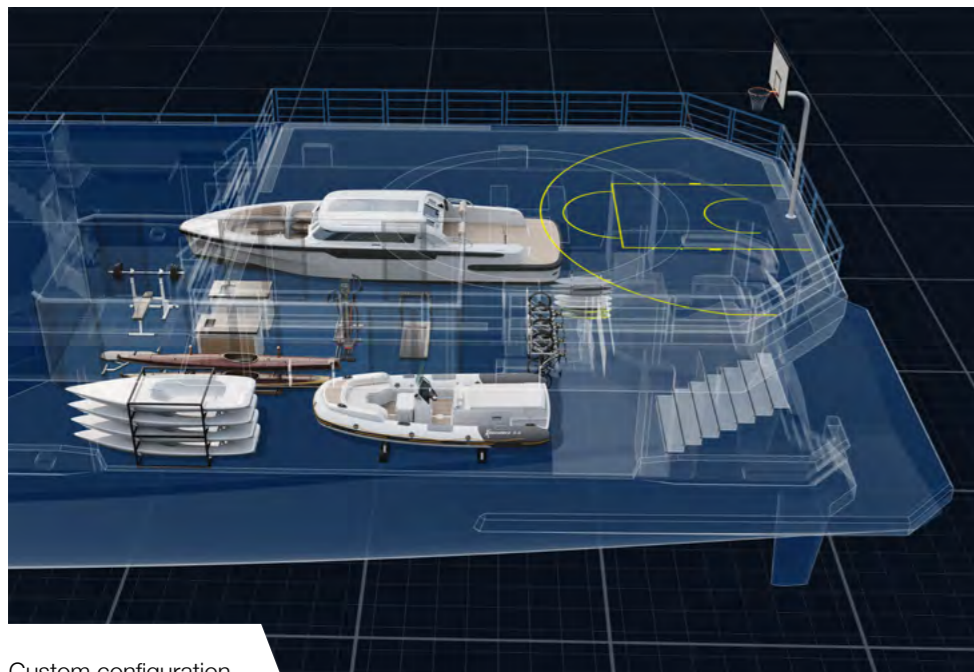

Custom configuration

INSPIRATION

- Vita LION fully electric tender
10.5 metres (34 ft)
- Laser XD racing sailboat
- Fun Air Climbing Wall
- Naish foil board
- Kitesurfing





- 195 square-metre outdoor area (3,000 sq ft) excluding tenders and toys
- Glass enclosed 44 square-metre space (474 sq ft)
- Juice bar and refreshments
- Fitness equipment
- Yoga, meditation and massage



MAIN DECK LOBBY

A transition area between the luxury interiors and the outdoor Main Deck sports areas, the lobby is approx. 20 square metres (215 sq ft).

FITNESS AND WELLNESS ZONE

On Main Deck Aft, create your own dedicated fitness and wellness zone. You can exercise both body and mind, privately situated to make the most of refreshing sea breezes, but out of the full glare of the sun.

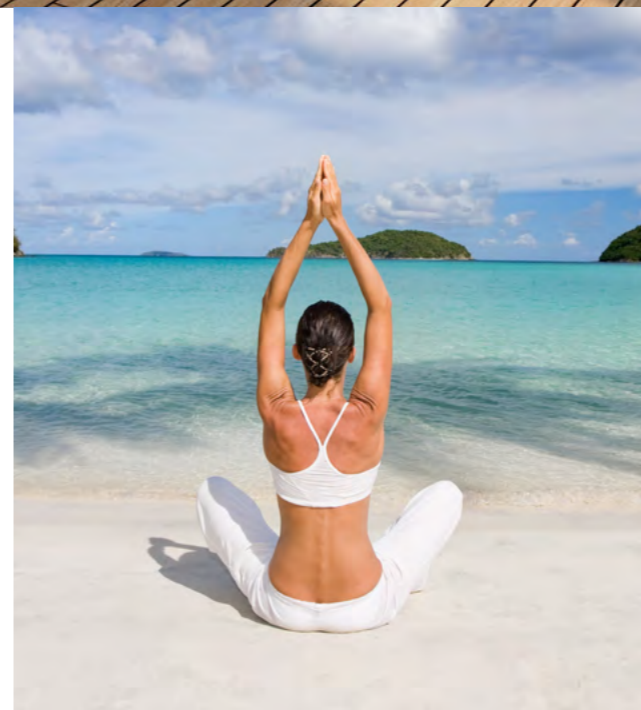

Luxury design
inspiration

03



INTERIORS

Our SeaXplorer 60 general arrangement features 347 square metres of luxury interiors (3,735 sq ft), plus another 33 square metres (355 sq ft) for the fully-enclosed Bridge Deck Sky Lounge with glass doors.

UPPER DECK LOUNGE AND DINING

Stepping inside on Upper Deck, the 60 square-metre Lounge and Dining (645 sq ft) is a haven of soft comfort, artwork and detailed finishes. H2's layout is comfortable, even cosy, while keeping a bit of formality and design pedigree. Rounded forms and organic shapes bring a cosy balance to the masculine exteriors. With exceptionally high comfort and low noise and vibrations, the only reminder that you are on a highly capable expedition platform is the stunning view outside.



Warm woods, textured fabrics and satin matt finishes add to H2's welcoming atmosphere – an oasis of comfort and style anywhere in the world. Reflective metal surfaces play with dimensions and perception.

OWNERS SUITE

The full-beam Owners Suite on Main Deck is expressive and personal with luxurious fabrics, decorative leather and warm woods. The curved headboard provides a grand entrance that playfully draws you around the space – an effect amplified in the soft oval ceiling dome. Portside is a private lounge and starboard an office – while mirrors slide open to reveal the walkthrough dressing and bathroom.



“The Owners Suite is very cosy without being heavy. It has a residential luxury feel. The display cabinets are metal, a bit industrial. They’re somewhere to store objects as you travel around the world, memories you pick up along the way.”

Jonny Horsfield - Director of H2 Yacht Design

Forward on Main Deck, the Owners Suite, His and Hers Dressings and Bathroom total 67 square metres (720 sq ft).



OWNERS BATHROOM AND DRESSING

A spacious sanctuary of privacy on board, the Owners Suite extends to the inner His and Her Dressings and then the Owners Bathroom.



“I like the bathroom’s crisp design language, very light marbles, it has an Italian feel. It’s a practical area, a good classic layout with lots of storage.”



The full-beam Owners Bathroom features a glass rainshower between twin vanities.





From both the His and Hers Dressings, panel sliding doors reveal the Bathroom. The Owners Suite has a private lounge area with ocean views (above left). On starboard a custom cantilevered desk is a space to focus (above right).

GUEST SUITES



Seen here in the twin Guest Suite, the large Main Deck windows bring the outside in. H2 created a fluid and clean wave in the desk shape to add elegance without distracting from the view.



Each of the five Guest Suites on Main Deck is approx. 20 square metres (215 sq ft) – each with a different configuration and individual character. Rippled leather and soft curves create a soothing atmosphere and retain that connectivity to the ocean that is prominent throughout the yacht's design.

H2's designs for each Guest Suite share a peaceful atmosphere created with indirect lighting and a balanced material palette of rippled leather, white lacquer and warm woods.

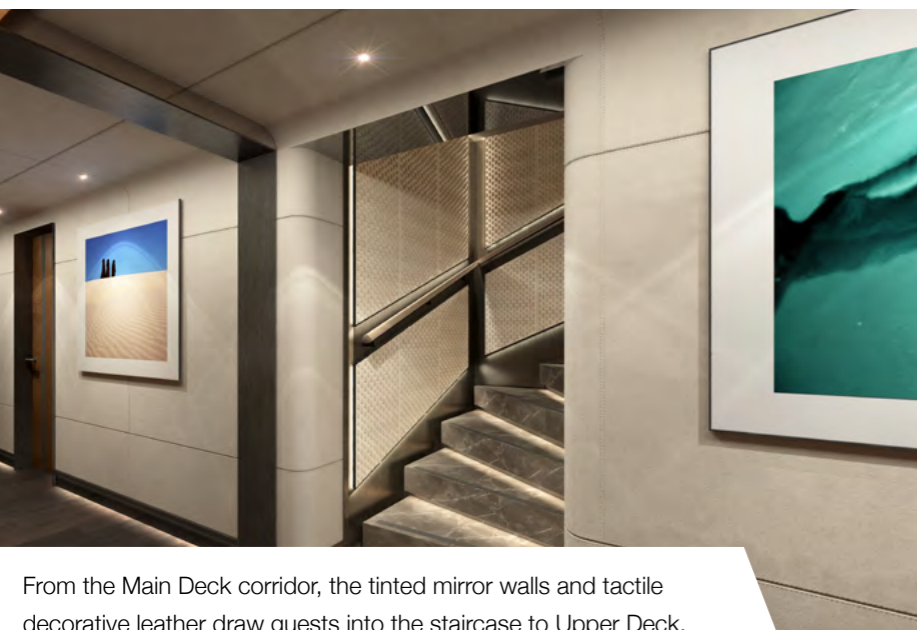

From the Main Deck corridor, the tinted mirror walls and tactile decorative leather draw guests into the staircase to Upper Deck.



Guests on Main Deck gather in the 20 square-metre Lobby (215 sq ft), a transition area before heading to the expedition areas aft.

PRIVATE COLLECTIONS

On Main Deck the corridor is a floating canvas for artworks and sculptural elements. Carefully created leather wraps the wall to ceiling, where offset lighting creates an asymmetrical focus on the gallery wall. Vertical recesses beautifully illuminate your private collections. H2's interior concept for the SeaXplorer 60 features photography by Annelies Damen and curated art pieces.



“I love to see how clients create inspiring and evocative spaces on their yachts, drawing from experiences from travel, architecture and art to influence their design choices.”

Annelies Damen - Third-generation family shareholder and member of the Damen Shipyards Group Supervisory Board



Our proven fleet

04



SHOWCASES

There is no mistaking the individual character that each Owner brings to their SeaXplorer. But underneath they share the proven technical platform and dedicated craftsmanship that is the foundation of every Damen Yachting delivery.

SX 58 (in build)

ANAWA

LA DATCHA

SeaXplorer in build for 2022 delivery

SX58

Her name was yet to be revealed, but the SX58 project was well underway as this brochure went to print. After signing in 2020, the Owner of this SeaXplorer specified a wide-range of custom features that make the SX58 a unique explorer yacht.



Custom features of this 58-metre SeaXplorer (190 ft) include a knuckle-boom crane on aft deck. This heavy-duty equipment means the helideck doubles as a carrying platform for a wide range of extra tenders and toys.

SX58

- Length overall 58 metres (190 ft)
- Exterior Design by Azure Yacht Design
- Interior Design by Design Unlimited
- Naval architecture by Damen Yachting
- Range 5,000 nautical miles
- Guests 12, Crew 17 + Captain

IN BUILD

Following design and engineering at our head office in the Netherlands, the SX58 project became the fifth Damen Yachting delivery from our Antalya facility. The yard in Turkey's premiere yacht building hub provides outstanding facilities supported by an experienced supply chain.

By starting the hull construction upfront, Damen Yachting was able to offer the experienced Owner a very customisable platform with fast delivery in less than two years. The Owner's choice for interior architect, Design Unlimited, has created a very personal and intriguing interior design that celebrates the spirit of exploration. From her delivery in 2022, she becomes the perfect expedition yacht for the Owner's lifestyle of adventurous globe-trotting exploration with family and friends.



Our SeaXplorer project team managed the build of the SX58 project at our Antalya facility.



ANAWA

When the 62-metre custom-designed ANAWA was handed over to her owners in 2020, she became the first delivery from our SeaXplorer range. She stands out with a charming colour scheme and expedition capability including helicopter hangar.

Her hybrid power generation system with a battery bank powers two electrical propulsion motors for an economical and environmentally friendly configuration. A private yacht for family and friends, the Owners selected Carlo Torre of Monaco Yacht Temptation to create a unique interior design.



Custom SeaXplorer with hybrid electrical drive



ANAWA

- Length overall 62 metres (203 ft)
- Exterior Design by Azure Yacht Design
- Interior Design by Monaco Yacht Temptation
- Naval architecture by Damen Yachting
- Range 6,000 nautical miles
- Guests 12, Crew 15 + Captain



*“This is cruising, but completely different.
The Earth is so big and our life is so short,
so we have to explore as much as we can.”*

Oleg Tinkov - Owner M/Y LA DATCHA



LA DATCHA

Drawn immediately to the SeaXplorer concept, the Owner of LA DATCHA had a unique vision for a yacht that combines adventure sport with the luxury experience. He spearheaded the extensive design process to customise the SeaXplorer platform.



LA DATCHA

- Length overall 77 metres (252 ft)
- Exterior Design by Azure Yacht Design
- Interior Design by Vasily Shprits
- Naval architecture by Damen Yachting
- Guests 12, Crew 24 + Captain
- Two Owner Suites, VIP Suite, plus three Guest Suites
- Autonomy at sea for up to 40 days
- Visit www.ladatcha.com for charter details

Whether in tropical or polar destinations around the world, LA DATCHA stands out with her remarkable colour scheme and large volume, six-deck superstructure – full of outdoor deck space.



“The pure and natural theme can also be recalled through the design themes incorporated into the interiors which draw the natural elements in with references to water, air, earth, wind and fire.”

Vasily Shprits Studio - Interior design



INTERIOR DESIGN

To create the interiors, the Owner selected designer Vasily Shprits, the architect behind all of the Tinkoff Collection LA DATCHA properties. Throughout the yacht's interior, there are hints of inspirational folk tales. For example the Russian folk tale about the man who had to pass through fire, water and copper pipes to save the girl he loved. This little 'Russian touch' can be found, for example, in the Main Salon where fire is literally featured in the dining table's fire pits, water is recalled through the bar counter's ice top feature and the coffee table's frozen liquid style and bronze detailing has been added throughout as an ode to the copper pipes.



Heliskiing is a big part of the LA DATCHA experience – with trips to the Kuril Islands, the Kamchatka peninsula, Chutotka and Alaska – and for that two helicopters are essential. LA DATCHA's unique helicopter solution perfectly meets the Owner's brief for this. There is the fully certified primary helideck, a standby deck for the second helicopter and both aircraft can fit in the below-deck hangar. She promises adventure without any compromise on luxury.



AVAILABLE FOR CHARTER

In the LA DATCHA Tinkoff Collection created by Mr Tinkov, luxury and sport go hand in hand. He offers his holiday homes to those who share his favourite passions in life – beautifully designed style and luxury while enjoying the world's top adventure sport destinations. Today LA DATCHA includes five of his residences, from alpine skiing in France to fishing off the Baja Peninsula. The LA DATCHA SeaXplorer 77 takes the concept a step further as an ocean-going luxury expedition yacht.

Your
configuration

05

SPECIFICATION AND BUILD

A love of doing things the right way is part of Damen Yachting's DNA. We believe in the value of uncompromising quality and meticulous attention to detail.



*How will you tailor our
General Arrangement for
the layout that suits you?*

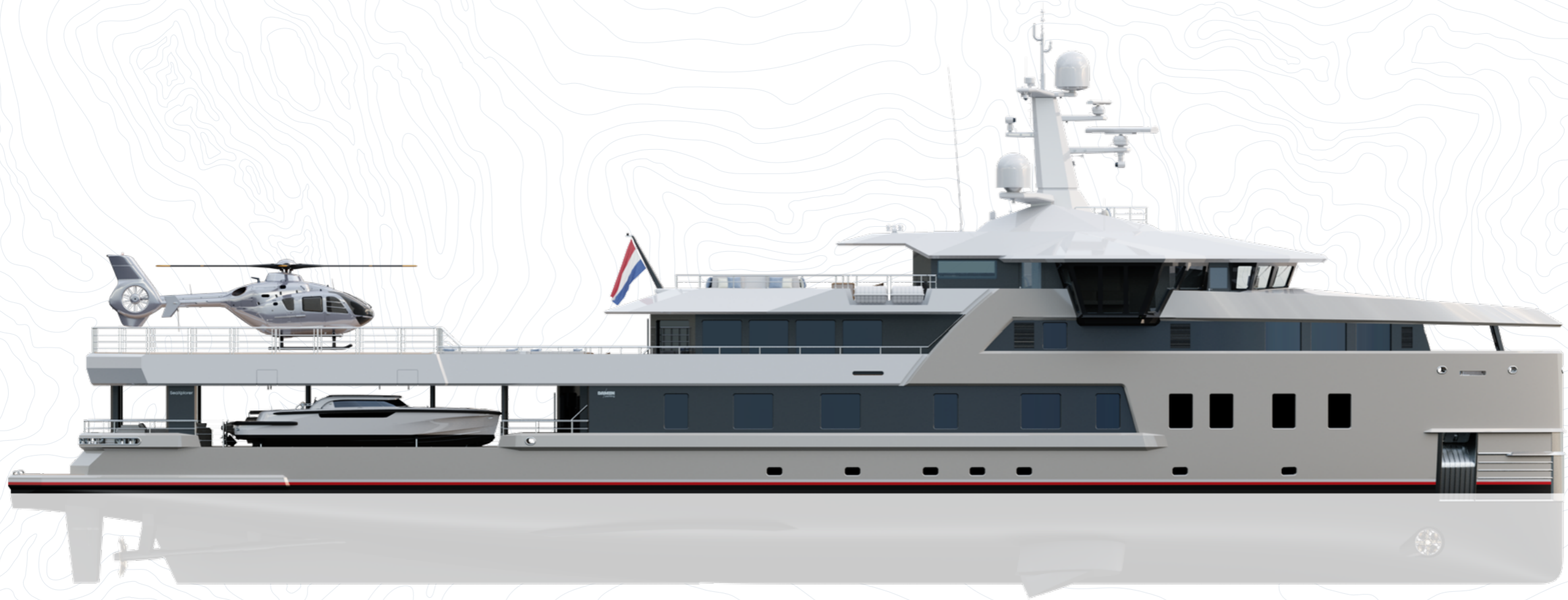

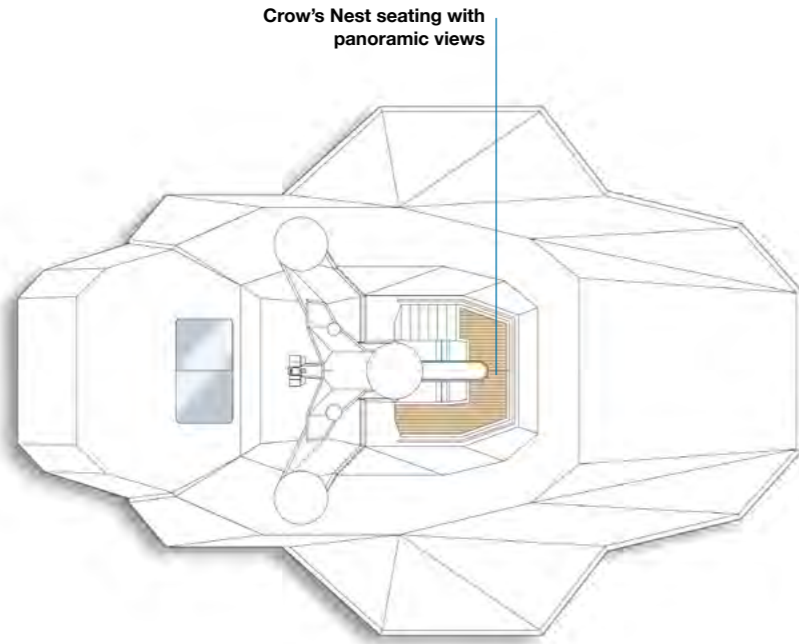

Crow's Nest seating with panoramic views

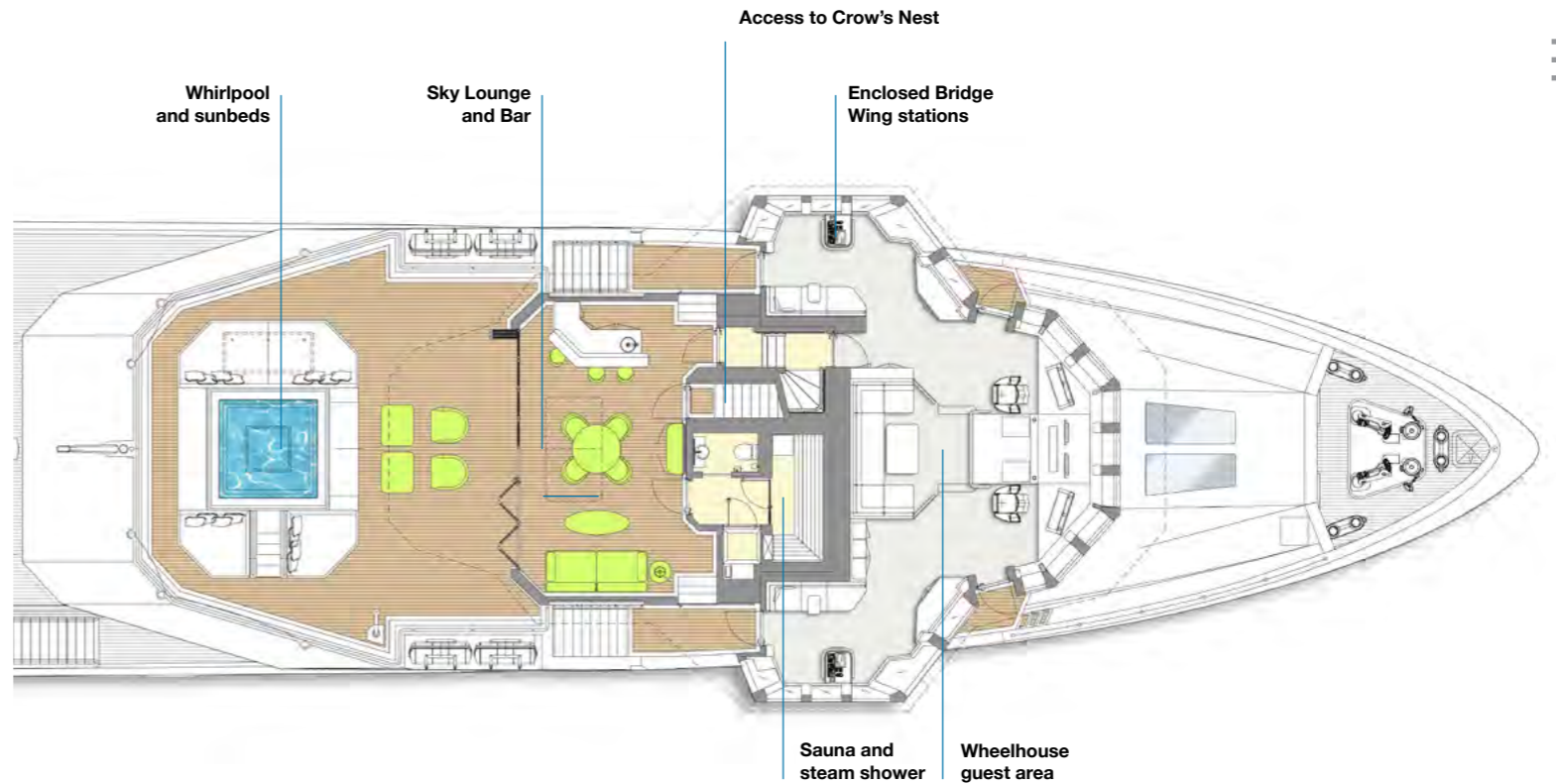

Whirlpool and sunbeds

Sky Lounge and Bar

Access to Crow's Nest

Enclosed Bridge Wing stations

Sauna and steam shower

Wheelhouse guest area

CROW'S NEST AND BRIDGE DECK

The top of the boat, the Crow's Nest, offers spectacular vistas. Take the stairs down and emerge in the 115 square-metre (1,238 sq ft) indoor-outdoor Sky Lounge with whirlpool. Forward, the wheelhouse is the expedition hub. Extended enclosed bridge wings provide the crew sightlines.

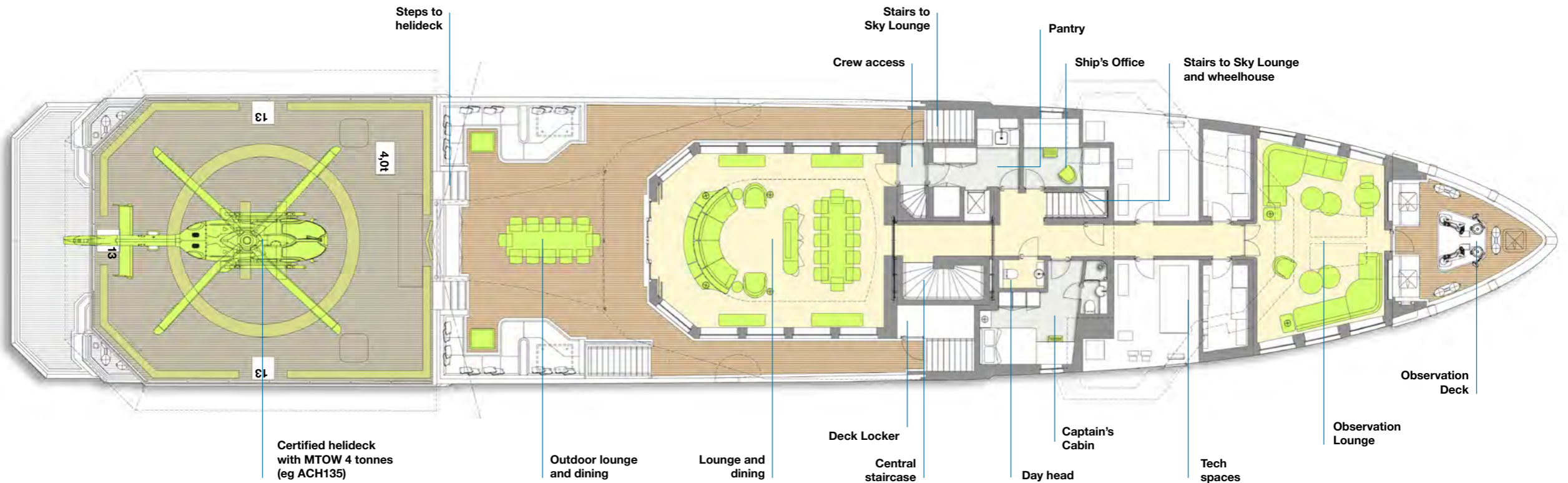

Steps to helideck

Stairs to Sky Lounge

Pantry

Crew access

Ship's Office

Stairs to Sky Lounge and wheelhouse

Certified helideck with MTOW 4 tonnes (eg ACH135)

Outdoor lounge and dining

Lounge and dining

Deck Locker
Central staircase

Day head
Captain's Cabin

Tech spaces

Observation Deck

Observation Lounge

- Luxury Interior
- Owners' Supplied Furniture
- Upgraded Crew interior

UPPER DECK

This deck is all about loving the outdoors! From the helideck (which is also a superb entertaining space) to the forward observation deck, there are views galore. The forward observation lounge is a unique space focused on the journey ahead. The outdoor dining area (under awnings if you wish) and lounge are the social hub on board.

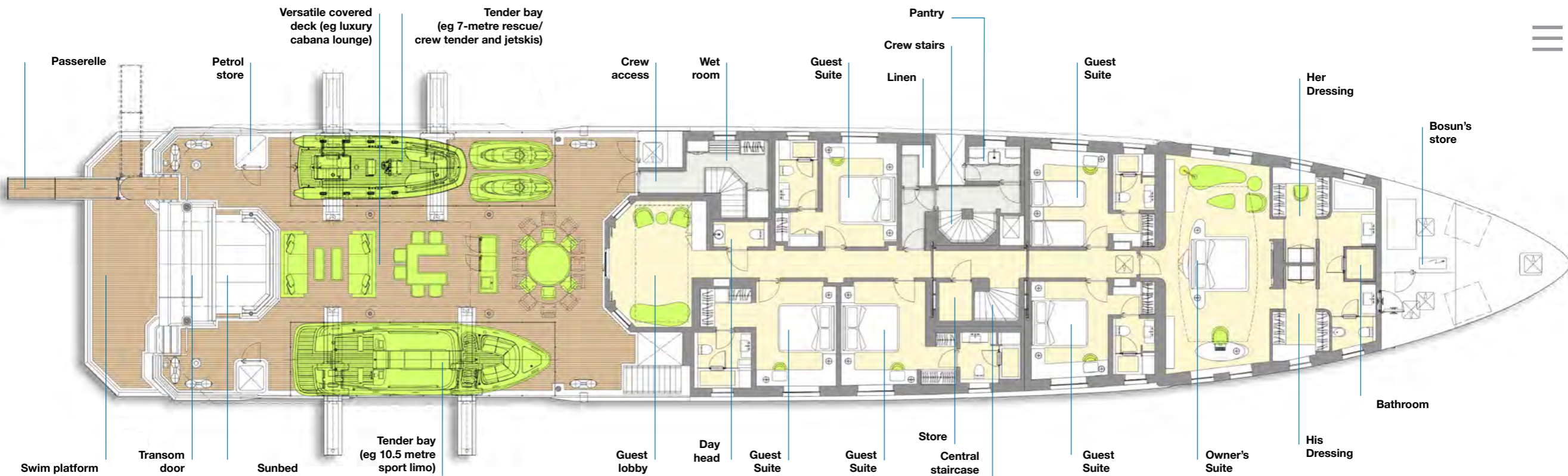

MAIN DECK

Come on down to Main Deck for spacious guest accommodation with six unique suites. The Owner Suite is a relaxing forward sanctuary. Aft is the spacious 195 square-metre outdoor area (3,000 sq ft). The space is designed for maximum flexibility – from carrying large tenders to outdoor entertaining.



LOWER DECK

There's a lot going on just below the waterline. This is where your Captain, 12 crew and 4 expedition staff are making your adventures happen. The SeaXplorer provides them with all the facilities, stores and technical equipment they need. Get inspired with our options for your multipurpose expedition store!

- Luxury Interior
- Owners' Supplied Furniture
- Upgraded Crew interior

WELCOME ON BOARD

SEAXPLORER 60

Builder	Damen Yachting
Portfolio	SeaXplorer
Naval architecture	Damen Yachting
Exterior designer	Azure Yacht Design
Interior design concept	H2 Design
Maximum speed	14.5 knots
Cruising range	5,000 nautical miles at 12 knots

MAIN DIMENSIONS

Length overall	60 metres (197 ft)
Beam overall	11 metres (36 ft)
Depth (midships)	5.5 metres (18 ft)
Draught (midships, summer load)	3.6 metres (12 ft)
Gross Tonnage	1,160



Luxury Spaces

- ✓ 658 square metres (7,083 sq ft) of outside deck space (usable area) from the aft Swim Platform to the towering Crow's Nest
- ✓ Luxury interiors over three guest decks (our layout offers 347 square metres net area / 3,735 sq ft)
- ✓ 2.1-metre ceiling heights (almost 7 ft) on Main Deck and above
- ✓ Ventilation and air-conditioning HVAC system designed for (summer) conditions of up to outside air 35°C @ 75 percent relative humidity and inside 22°C @ 50 percent relative humidity

LUXURY ACCOMMODATION

- 6 x luxury suites for 12 guests:
- Owners Suite on Main Deck with stateroom, bathroom and His and Her Dressings (67 square metres / 786 sq ft)
- 5 x Guest Suites (approx. 20 square metres / 215 sq ft each) on Main Deck

EXPEDITION, CREW AND TECHNICAL SPACES

- Technical 283 square metres (3,046 sq ft) like the engine room, audiovisual and air-conditioning spaces
- Crew spaces 382 square metres gross area (4,112 sq ft) for service areas and pantries, galley, laundry, crew accommodation, mess and gym (320 square metres net area / 3,445 sq ft)
- Provisions and storage 85 square metres (915 sq ft) storage and cool/dry stores (excluding technical and bosun store)

YOUR INNER EXPLORER



TENDERS

- Fully certified helideck suitable for Maximum Take Off Weight up to 4,000 kg, D Value 13 (eg Airbus H135 twin-engine)
- 10.5-metre starboard tender bay (34 ft) eg Pascoe sport limo tender, maximum weight 5,000 kg
- 10.5-metre portside tender bay (34 ft) or 7-metre crew/rescue tender + 2 x Jetskis, maximum weight 5,000 kg

MULTIPURPOSE EXPEDITION STORE

The 40 square-metre Lower Deck store (430 sq ft) is suitable for toy storage. The space includes a crew workbench and store that leads into the yacht's technical areas. Depending on your operational requirements, you can use this space for:

- Dive gear, watersports equipment, bikes and more
- Science and education Wet lab
- Helifuel tank and refuelling station

CREW QUARTERS

- Total 17 crew and expedition staff
- 13 crew (1 Captain, 12 crew)
- 4 expedition staff, guides, pilots (2 in commercial use)
- Crew Mess and Lounge
- Ship's office
- Engineer's office and switchboard room
- Dedicated crew entry and ship security system

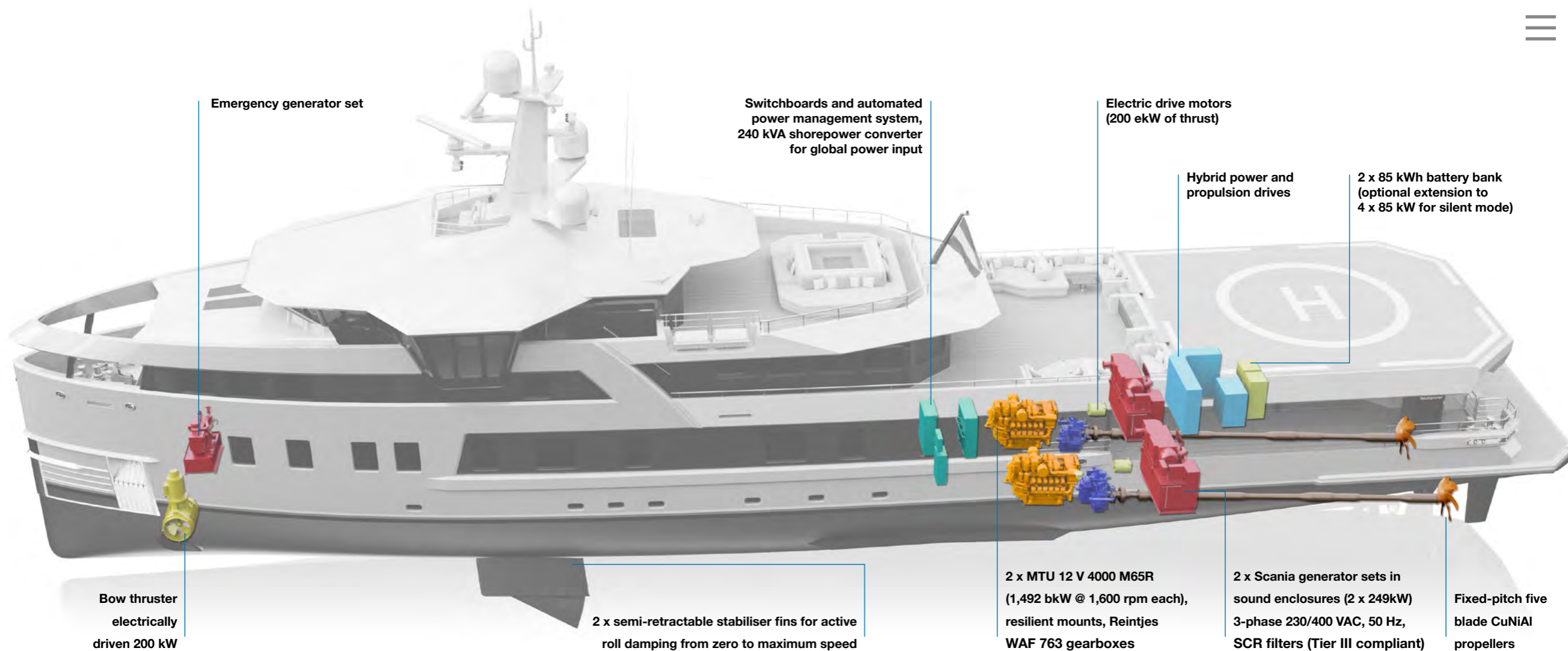









HYBRID POWER AND PERFORMANCE

The SeaXplorer 60 Hybrid system uses PTO/PTI technology in combination with battery bank power. Multiple sources of energy work together seamlessly, ensuring the highest efficiency throughout a wide operating profile. You reduce harmful emissions, reduce noise and vibrations while benefiting from lower fuel and maintenance costs.

- 5,000 nautical miles range at 12 knots cruising speed, maximum speed 14.5 knots
- Fuel capacity of 188,000 litres (49,664 gallons)
- Maximum outside air temperature 45°C, maximum seawater temperature underway 32°C
- Minimum outside air temperature -10°C, maximum seawater temperature underway -1.5°C



MODE	HOW IT WORKS	SPEED	ENGINE SOUND	LIFESTYLE BENEFITS
Serenity 	Battery 	 0 knots		At the marina or in harbour, enjoy uninterrupted smooth service, supported by the shore convertor or a single sound-enclosed generator.
Silent cruising 	Battery + Generators  +  	 8 knots		Travel gracefully and quietly, propelled by just the hybrid electrical drive motors (200 ekW of thrust).
Eco cruising 	Battery + Main engines  +  	 8-14.5 knots		Maximise efficiency with main engines generating electrical power (300 ekW hotel load) as well as propulsion.
Full power 	Battery + Generators + Main engines  +   +  	 14.5 knots		An abundance of power with maximum speed and full hotel load enhanced with battery back-up.

HYBRID POWER AND PERFORMANCE

REDUCING HARMFUL EMISSIONS

We are the industry leader in Selective Catalytic Reduction (SCR) filters that slash harmful NOx emissions by 70 percent. In your SeaXplorer Hybrid system, both your main engines as well as the generator sets operate SCR filters with full transatlantic range (5,000 nautical miles), complying with the most stringent International Maritime Organization requirements for unrestricted global cruising. We also use exhaust gas soot filters on generators for cleaner emissions.

HAPPY ENGINES THANKS TO HYBRID POWER

Your yacht's engines are happiest running at a consistent 80-90 percent load – burning fuel efficiently with a lean mixture. The SeaXplorer Hybrid system applies the optimum number of engines running at optimum load with batteries to absorb fluctuations in demand – for example peak demands from your air-conditioning, galley or bow thruster. With a steady optimum load, you avoid unnecessary engine load fluctuations and unnecessary starts and stops, so your engines burn fuel efficiently while wear and tear decreases. You save fuel and maintenance costs.



Half Load – Stressed Engine



Full Load – Happy Engine

Battery power isn't just for propulsion - it also keeps your engines performing quietly and reliably.



SELF-SUFFICIENT BY NATURE

- Expedition facilities
- Stores
- Tanks

30 DAYS AUTONOMY

- Up to 30 days of 12-guest full luxury service with no port calls.
- 36,000 litres fresh water tanks (9,510 US gallons)
- 2 x 12,000 litres reverse osmosis fresh water makers (3,170 US gallons each per day)
- 18 cubic metre garbage store and -5 to 5° C chiller with compacters for baling waste and glass crushers, under pressure to prevent smell contamination
- Approx. 55 cubic metre dry, cool and freeze provisions stores, including 3 x wine fridges for 500 bottles in controlled temperature zones
- Hospital quarantine (separate air and wastewater systems) and remote medical diagnostics
- Extra-large laundry and linen stores
- Fuel capacity of 188,000 litres (49,664 gallons) for 5,000 nautical miles range at 12 knots cruising speed

ENVIRONMENT

- IMO Polar Code compliant (category C vessel)
- 52,000 litres greywater tanks (13,737 US gallons) and waste management system for operation in zero-discharge zones such as marine natural reserves
- Selective Catalytic Reduction (SCR) filters (Tier III compliant) to reduce NOx emissions by 70 percent
- 7,000 litres (1,849 US gallons) urea solution capacity for low-emission SCR system operation with full range autonomy (5,000 nautical miles) at standard 40% concentration
- Soot filters for main generator exhausts
- Heat Recovery system using residual engine heat for potable water heating and improved HVAC efficiency
- Energy saving LED lighting for both interiors and exteriors
- All guest windows are double-glazed to insulate against both temperature and noise. An additional window heat absorption layer further reduces HVAC air-conditioning power demands.

EXPEDITION FACILITIES

- Tender and equipment bays with overhead crane deployment
- Petrol store storage rack for 500 litres petrol (132 gallons) in 25 jerry cans
- Crew wet room (Main Deck)
- Crew workbench and store (Lower Deck)
- Heli fuel station (optional) 3 cubic metre tank (660 US gallons) and refuelling skid
- Expedition staff cabins (pilots)
- Luggage and equipment store (Tank Deck), with hatch access from crew corridor

TOP QUALITY AND SAFETY

The process of completing your SeaXplorer starts at one of Damen's hull building yards. Under the supervision of our project management team, the craftsmen and women at our specialists yards assemble the steel and aluminium before the hull hits the water for the first time and the outfitting phase begins.

MATERIALS

- Steel hull with scantlings, welds, plating and stiffeners engineered by Damen Yachting for minimum noise and vibrations, with Ice Class steel ice belt
- Aluminium and steel superstructure
- Faired and painted to perfection with the highest acceptance criteria in modern, climate and humidity controlled covered facilities
- Teak decks with first class grade quarter sawn 55-mm (visible) wide teak



SAFETY AND COMPLIANCE

- Classification Lloyd's Register 100A1 SSC Yacht Mono G6, [M] LMC, SCM, UMS, Ice class 1D [Hull:1C FS], Eco, Hybrid Power
- Fully certified according to Red Ensign Group Large Yacht Code Part A (LY-A) as surveyed by CISR
- Flag state Cayman Islands (Ask about Marshall Islands or alternatives)
- Certified SOLAS rescue boat and life rafts
- Watertight integrity with one-compartment flooding stability and buoyancy in the event of collision or damage



- Lloyd's Register ECO notation, technically prepared for compliance
- Waste water treatment plant: effluent quality as per IMO MARPOL MEPC.159 and US Coast Guard approved (type II) for foreign vessels visiting US coastal waters
- Bio friendly anti-fouling paint certified TBT free
- Quality Management system of the Builder has been approved by DNV Quality Assurance to the ISO 9001: 2008 standards
- Emergency generator set 110 kW, powering all primary safety and navigation systems including satcom c ship security alert system



CERTIFIED HELICOPTER LANDING AREA

The SeaXplorer 60's helideck complies with Annex 6 of the Large Yacht Code; technical standards for helicopter landing areas. Unlike the unregulated 'touch-and-go' surface typically seen on conventional yachts, certified helideck regulations demand wide-ranging design features for safe landings – night, day and underway in a wider weather window. The certified helideck also permits operations during charter and commercial use.

- Clear heavy duty, non-slip surface large enough for the full diameter of the aircraft with rotors turning
- No obstacles or deck protrusions in close proximity that can create structure-induced turbulence and thermal effects

- Pilot visual aids including aiming circle, markings, dedicated perimeter night landing lights and floodlights
- Minimum camber and gutter system
- Tie-down lashing points for temporary sea fastening
- At least two access/egress routes to the helicopter landing area
- Wheelhouse helicopter monitoring system, including precision meteorological/barometric data, motion sensor heave, ultrasonic anemometer, visibility and present weather sensor, cloud base sensor
- Firefighting installation with foam tank; heli store fire locker for firefighting and emergency response equipment

IMO POLAR CODE COMPLIANT

- Category C certification for safe operations in pack ice concentration up to 70%

The SeaXplorer 60 complies with the International Maritime Organization's Polar Code, a set of safety and environmental regulations in force since January 2017 for all vessels entering Arctic and Antarctic waters. The Polar Code is applicable (in general) above 60° north and below 60° south (see illustration). Even small changes in polar winds and currents can quickly lead to your yacht being surrounded by close pack ice, which can be very dangerous for yachts without extra strengthening.



WE DELIVER WHAT WE PROMISE

Damen Yachting is a strong international team of 500 men and women. From our North Sea head office in Vlissingen, the Netherlands, we operate the world's largest superyacht building and refit facilities – leveraging Damen's global network of yards and service hubs. In addition, we work closely with co-makers, crew and owner representatives based at our yards.



INHOUSE DESIGN AND ENGINEERING

“Starting with the platform’s detailed engineering, we can customise your SeaXplorer with top shelf 3D development software created for advanced military and aviation design.”

Enrique Tintore - SeaXplorer Design Manager



PROJECT MANAGEMENT

“You have an entire shipyard of people who share the same work ethos, dedication and desire to ensure that each and every project absolutely meets and exceeds the client’s wishes. It forms an unwavering motivation that steers us all to deliver complete client satisfaction.”

Sjoerd van den Broek - Manager Projects



CUSTOMER CARE

Our job as builder doesn't end at delivery. Wherever you are in the world, the industry's best Customer Care team is standing by. They manage any warranty points and provide advice and services. They know our yachts inside out and can quickly source original spare parts and suppliers.

Contact the team directly at: customercare@damenyachting.com

"It's about being proactive, working with captains and crews to ensure the uninterrupted Amels and Damen Yachting experience for our clients. Basically, we want to do everything we can to create the highest standard experience. That's what Customer Care means to us."

Onno Piesens - Head of Customer Care



Your world in range

DAMEN YACHTING PORTFOLIO

Create the most unforgettable luxury yachting experiences with our market-leading portfolio. At Damen Yachting, the yacht building division of the Damen Shipyards Group, we build Amels yachts, SeaXplorer yachts as well as specialist Yacht Support vessels. Which yacht suits your yachting lifestyle?

“As Damen Yachting we apply our talents across a wide portfolio of yachts and services to create the absolute top luxury yacht experiences for you. I’m very proud to lead such a dedicated team of yacht builders.”



Rose Damen
Managing Director

AMELS

DAMEN
/yachting



Discover your world beyond limits

SEAXPLORER

Our SeaXplorer premiere expedition yachts offer serious global exploring capability, combined with luxury refinement at home in any marina. These yachts are the ultimate crossover of high-volume luxury accommodation with a true expedition platform designed to take you anywhere in the world in complete safety, comfort and style.

SEAXPLORER 60

60 metres (197 ft)
1,160 Gross Tonnage



SEAXPLORER 77

77 metres (252 ft)
2,550 Gross Tonnage



SEAXPLORER 105

105 metres (345 ft)
6,500 Gross Tonnage



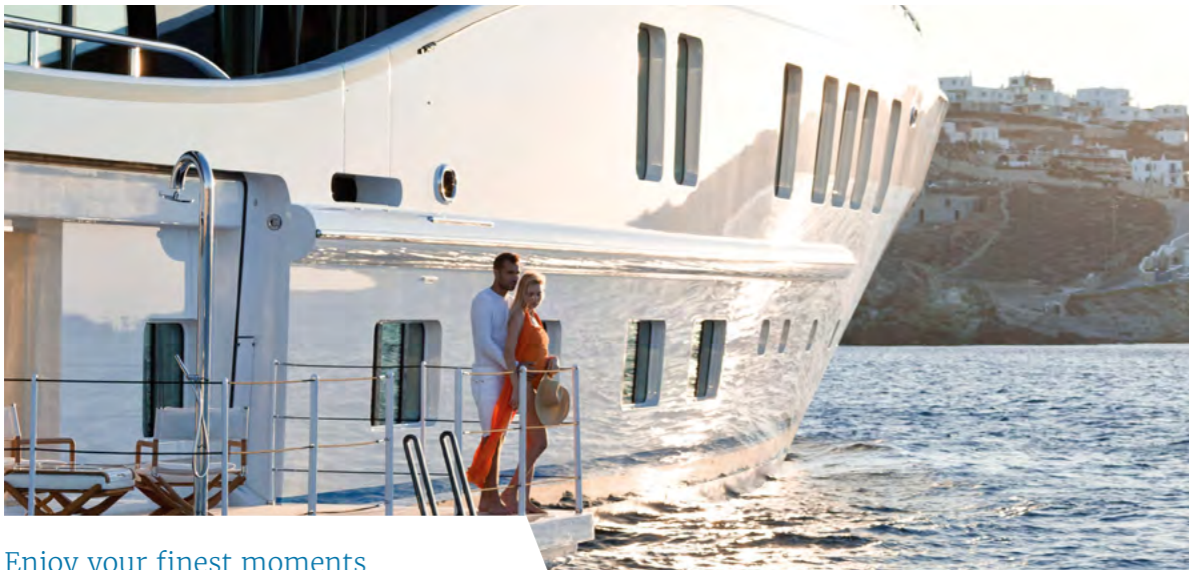

Enjoy your finest moments

LIMITED EDITIONS

Our Amels Limited Editions yachts are world-renowned. Our innovative business model of upfront investment in engineering and construction, while maximising customisation for owners, represents the perfect balance between full custom and semicustom – and reduces delivery time from several years to as little as a few months.



Maximise the moment

YACHT SUPPORT

Owners take vessels from our purpose-built Yacht Support range all over the world to support superyacht operations and make the best use of precious time at sea. Enjoy exotic destinations and dive spots with less developed infrastructure without turning the mother yacht into a cargo and equipment carrier.



The art of yacht building

FULL CUSTOM

For a complete custom yacht with your own exterior and interior designers, we offer Full Custom. There's a lot of pedigree behind our custom building, including 35 Amels Full Custom yachts. Our top team of yacht building experts has long experience collaborating with world-renowned designers and architects.

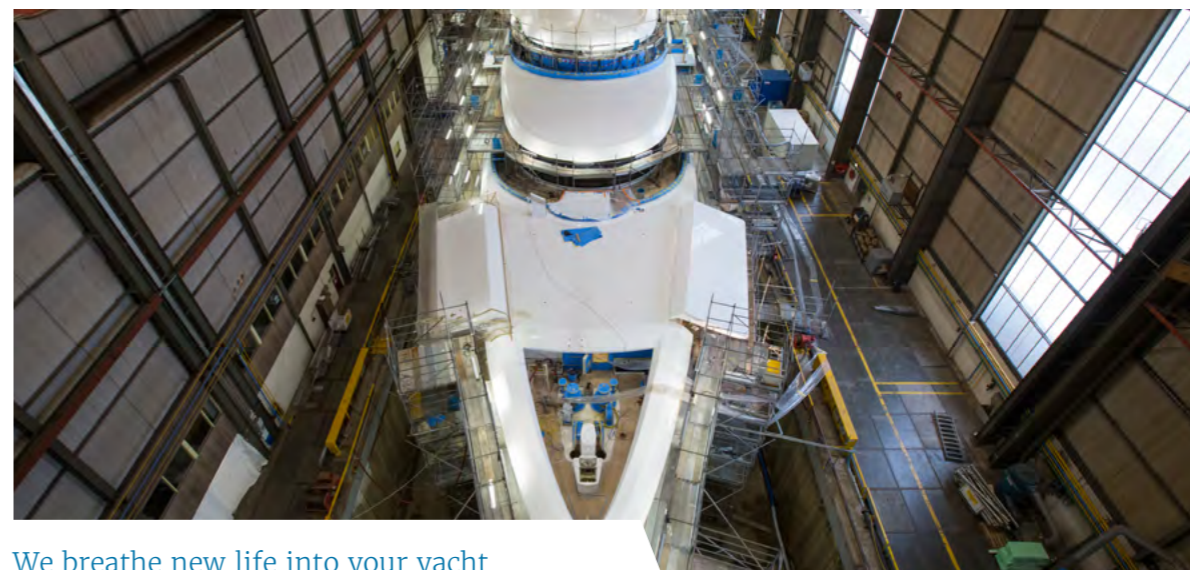

We breathe new life into your yacht

REFIT

With Amels and Damen Yachting Refit we offer owners of both our fleet of yachts and other brands comprehensive yacht refit services. From planned maintenance to complete transformations, we have an impressive track record.

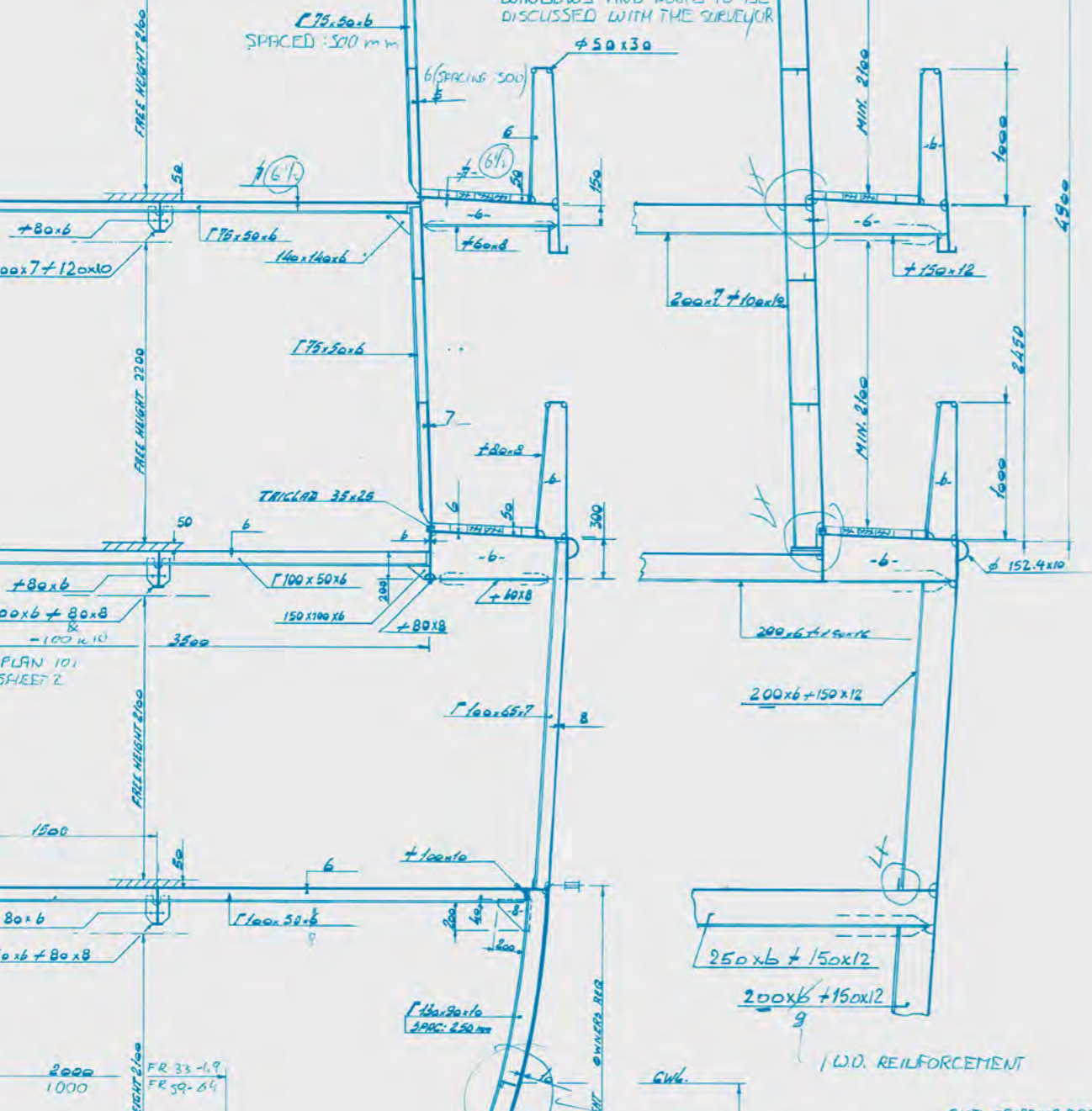

Rose Damen, (centre) daughter of Chairman Kommer Damen, is Managing Director of the group's Yachting division.

Our family business



A SHIPBUILDING HERITAGE STRETCHING BACK CENTURIES

Damen Yachting has a rich history in luxury yacht building. In 2018 we celebrated 100 years of Amels and we can trace the maritime DNA at our yards back for centuries. The ground beneath our feet is steeped in shipbuilding tradition, a maritime DNA that has shaped our docks and locks, but also the working lives of generations of craftsmen and women. It's a heritage that we are proud to continue.

An icon of modern Dutch industrial entrepreneurship, the Damen family is not only a committed 100 percent owner behind all our Amels, SeaXplorer and Yacht Support products but also very much involved in the day-to-day business at Damen Yachting. Since acquiring Amels in 1991, the Damen family has continued to invest in its yacht building business, which is today a cornerstone of its iconic shipbuilding group.

Taking over his father's shipyard in 1969 with six employees, Chairman Kommer Damen has grown the business into Damen Shipyards Group, the world's leading specialist shipbuilder with 12,000 employees and 35 shipyards around the globe. Damen builds an incredible portfolio of high-tech vessels – from sophisticated navy combatants to high-speed Coast Guard craft and deep-sea research vessels.



*“I define exploration
as curiosity acted upon.”*

OCEAN EXPLORER DR DON WALSH

The first human to reach the ocean's deepest point.



DISCLAIMER

All information, specifications, descriptions and images in this brochure are considered preliminary, non-binding and subject to change by Damen Yachting. All equipment shown is purely for inspiration and illustrative purposes and is not supplied or endorsed by Damen Yachting. Custom deployment on board the SeaXplorer is subject to feasibility study and may require owner-specified engineering. Damen Yachting accepts no responsibility for the use of any owner supplied equipment on board.

COPYRIGHT

Brochure SeaXplorer 60 print version 1.0 © Damen Yachting, 2021. No images herein may be reproduced in any form without written permission of Damen Yachting. Exterior yacht renders created by Schöningh Wulffraat for Damen Yachting.

Additional imagery courtesy of:

Airbus, m/y ANAWA, Annelies Damen, m/y BELLE AIMEE, m/y DRIFTWOOD, EYOS Expeditions, m/y GENE MACHINE, Fun Air, H2 Design, m/y LA DATCHA, m/y LILI, Pascoe, Shelton du Preez, SX58 Owner and team, Tec Wire/Nautec Experience, Tom van Oossanen, Vita Power, U-Boat Worx, XTender.

Damen Yachting

Koningsweg 2
4381 NA Vlissingen
The Netherlands

+31 118 485002
info@damenyachting.com

damenyachting.com

SeaXplorer 60