

SHORT
DELIVERY
TIME



DAMEN SHADOW VESSEL 8316

SUPPORT, SECURITY & EXPEDITION VESSEL

DAMEN



An unique eye-catching design, which stands out from anything else in the market. Our vessels are designed with a strong emphasis on functionality, operability and ease of maintenance. Other important design aspects are an excellent sea keeping behavior, safety and high level of comfort, based on a state of the art and well proven ship design.



Certified helideck suitable for helicopters with a D-Value up to 16. (e.g. Black Hawk, AW 139, EC 135)

420 m² deck space, for storage of:

- Tenders, Interceptors and Speed boats
 - Seaplane
 - Submarine
 - Expedition gear
 - Diving decompression chamber
 - Cars
- and much more...

All well protected from sea water by high bulwark and superstructure



The slender hull of the Shadow Vessel reduces fuel oil consumption, not only in calm water but especially in rough seas. Slamming has been reduced to very low levels, which results in improved comfort and safety for the crew, vessel and cargo. The accommodation is designed to high standards and each cabin has access to the Internet, radio and TV. The vessel is provided with a certified helipad. There is a spacious aft deck providing stowage for multiple tenders, speedboats, submarine, dive decompression chamber, expedition equipment.

We at Damen believe that there has to be a perfect balance between work and recreation. Both, however, should take place in an environment that is safe, comfortable, quiet, durable, easy to maintain and inspiring. And your crew should feel at home. We strived for an optimum design and we have selected high quality materials while meeting the requirements of applicable regulatory agencies.

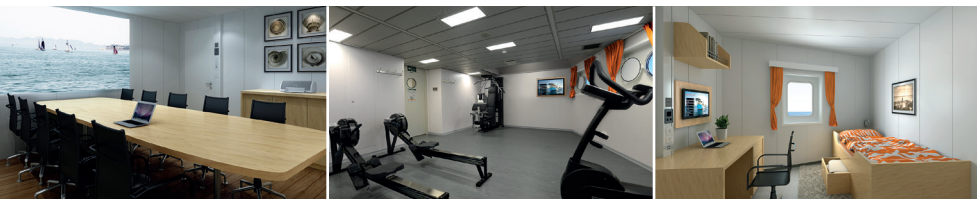

GENERAL

Basic functions	Expedition Support ✳ 100A1, ✳ LMC, UMS, DP(AM), Fi-Fi 1 with water spray, Expedition Support Vessel *
Descriptive note: Flag	

DIMENSIONS

Length o.a. (incl. platform)	83.10 m
Beam mld.	16.20 m
Depth mld.	7.50 m
Draught (operational)	4.50 m
Deadweight (approx.)	1500 t
Open deck area	420 m ²

TANK CAPACITIES

Ballast	1460 m ³
Fuel oil (service)	600 m ³
Potable water	800 m ³
Fuel oil for yacht fleet	900 m ³
Heli fuel	8 m ³
Gasoline for tenders / speed boats	4 m ³

RANGE / AUTONOMY (APPROX.)

Range	8500 nm
Autonomy	35 days
Autonomy at anchor	3 months

PERFORMANCES (APPROX.)

Speed (at 5.00 m draught)	13.5 kn
---------------------------	---------

PROPULSION SYSTEM

Main engines	Diesel-Electric, 690 V, 60 Hz
Propulsion power	2x Electric motors of 1500 kW each
Azimuthing thrusters	2x 2300 mm FP propellers in nozzles
Bow thrusters	2x 735 kW, 1740 mm, FPP

AUXILIARY EQUIPMENT

Networks	690 V, 440 V and 230 V – 60 Hz
Main generator sets	2x 1360 kW at 1800 rpm 2x 940 kW at 1800 rpm
Emergency/harbour generator set	1x 238 kW at 1800 rpm
Shore supply	1x 200 A
Heating	Electric boiler combined with waste heat system

DECK LAY-OUT

Anchor mooring winch	1x Electric-hydraulic, with 2 warping heads and rope storage drums
Capstans	2x Electric-hydraulic, each 5 t pull
Tugger winch	2x Electric-hydraulic, each 10 t pull
Helideck	Suitable for Black Hawk or AW 139 (6.8 t)
Heli hangar	Optional
Deck crane	2x swl 3.6 t at 14.58 m, 13.5 t at 4.86 m (e.g. Wajer, Interceptor, Xtender, Zodiacs)

ACCOMMODATION

Guest	6 persons
Crew	12 persons
Staff	42 persons*
Cabins provided with Internet, telephone and satellite TV. Common areas include gym, lounges and storage spaces	

NAUTICAL AND COMMUNICATION EQUIPMENT

Nautical	Radar X-band + S-band, ECDIS, Conning
DP-system	DP-2
GMDSS	Area A3

OPTIONS

A-frame	Larger crane
2nd helideck	Helicopter hangar

* Number of people on board during operations T.B.D. with flag and authorities

DAMEN SHADOW VESSEL 8316

SUPPORT, SECURITY & EXPEDITION VESSEL



The Damen Shadow Vessel is a versatile vessel specifically tuned to support superyachts, cruise vessels and to offer crew support. It provides:

- Guest accommodation with own lounge and galley
- Large accommodation for staff, security personnel and crew
- Tank capacity for long endurance of shadow vessel and yachts

- Huge deck storage for toys
- Certified helideck
- Safety standby for support, security and evacuation
- Fire Fighting capabilities

The sturdy built vessel (Offshore Standards) is capable for worldwide operations meeting highest standards of class and authorities.

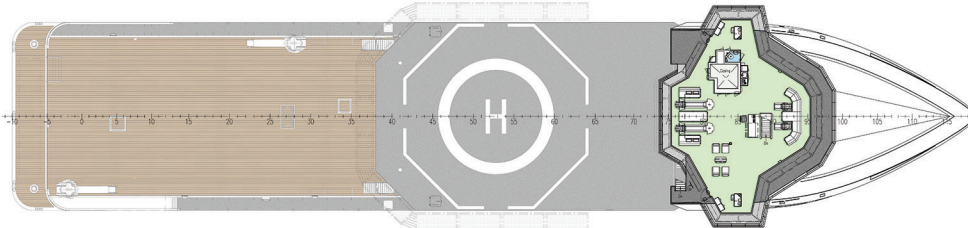

Bridge Deck

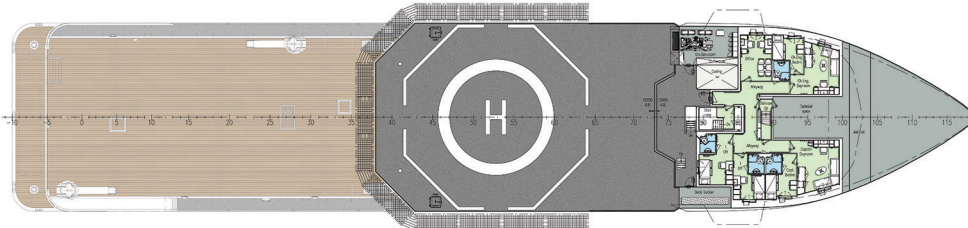

C Deck

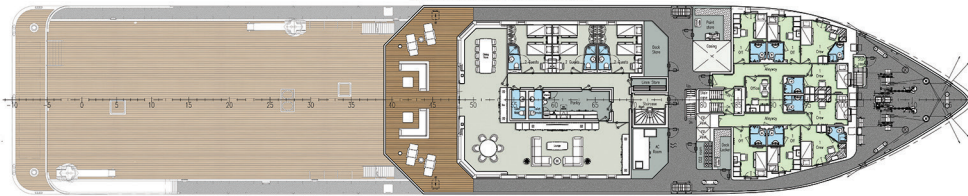

B Deck

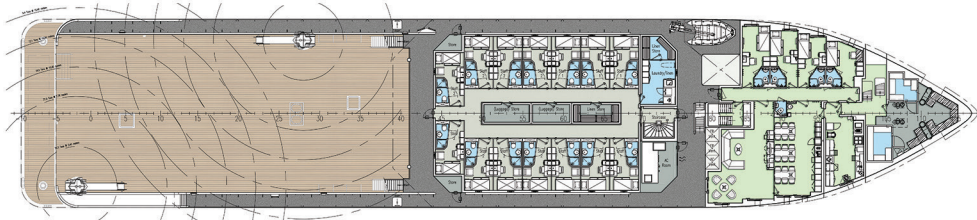

A Deck

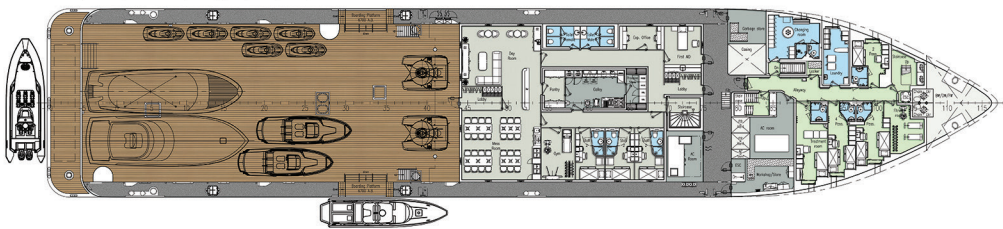

Main Deck

DAMEN

DAMEN SHIPYARDS GORINCHEM

Avelingen-West 20
4202 MS Gorinchem
The Netherlands

P.O. Box 1
4200 AA Gorinchem
The Netherlands

phone +31 (0)183 63 99 22
fax +31 (0)183 63 21 89

Member of the DAMEN SHIPYARDS GROUP



info@damen.com
www.damen.com