

Multi Cat 3013

STANDARD



PICTURE OF SIMILAR VESSEL

GENERAL

Basic functions	Anchor handling, dredger service, supply, towing, hose handling and survey
Classification	Bureau Veritas; I * Hull • MACH Tug (design bollard pull 35 ton) Unrestricted navigation • AUT-UMS

DIMENSIONS

Length overall	30.15 m	
Beam overall	13.40 m	
Beam moulded	12.50 m	
Depth moulded (1/2 length)	3.80 m	Deadweight ↓
Draft maximum	2.60 m	180 ton
Deck area	170 m ²	
Deck load	12 t/m ²	
Gross tonnage	345 GT	

TANK CAPACITIES

Fuel oil	180.0 m ³
Fresh water	53.0 m ³
Sewage	6.8 m ³
Dirty oil	4.4 m ³
Lubrication oil	2.8 m ³
Bilge water	2.8 m ³
Hydraulic oil	4.4 m ³
Technical water aft	25.0 m ³
Technical water fore	30.0 m ³

PERFORMANCES

Bollard pull	35.0 t
Speed	10.0 kn

PROPULSION SYSTEM

Main engines	3x Cat C32 TTA ACERT – A-rating
Engine power	3x 746 bkW @ 1800 rpm
Total Power	2238 bkW
Gearboxes	3x Reintjes WAF 563L - 5.947:1
Propulsion	3x Promarin fixed pitch propellers
Propeller diameter	3x 1700 mm in Optima nozzles
Bow thruster	Hydraulic driven, 294 kW – 400 pk

AUXILIARY EQUIPMENT

Generator sets	2x Caterpillar C04.4, 86 kW, 107 kVA each, 50 Hz
Hydraulic power	1x Caterpillar C32 TTA, 634 kW, 1800 rpm
Transfer pump fuel oil	1x Azcue CA80/20A 50 m ³ /hr @ 4.75 Bar
Transfer pump freshwater	1x Azcue CA80/20A 50 m ³ /hr @ 4.75 Bar
Fuel oil separator	1x Alfa laval, MIB 503, 1000 l/hr
Cooling system	Boxcoolers

DECK LAY-OUT

Anchor	1x 360 kg HHP, 1 stored
Anchor winch	1x Kraaijeveld KAB-1-H-19D, hydraulically driven
Deckcrane fore	1x HS Marine AKC 410 HE2 – 22.8 t @ 13.1 m
Deckcrane aft	1x HS Marine AKC 410 15.5 HE3 - 17.1 t @ 15.5 m
Anchor Handling winch	1x Kraaijeveld KA-30/2-H-TR Pull 150 t @ 8 m/min, 25 ton @ 32 m/min BHL = 170 ton @ first layer Wire capacity 600 m of Ø 40 mm
Towing winch	1x Kraaijeveld KA-20/2-H-TR Pull 40 t @ 12 m/min, 12 t @ 24 m/min BHL = 100 ton @ first layer Wire capacity 900 m of Ø 40 mm
Towing pins front	1x DMC double pin with chain stopper
Tugger winch	2x Dromec HPV-12000 SWL 12 ton @ 5 m/min
Bowroller	Diameter 1200 mm, SWL 170 ton, length 6 m
Sternroller	Diameter 1200 mm, SWL 100 ton, length 3 m
Moonpool	1x integrated moonpool diameter 1.0 m
Spud holes	2x integrated spudpoles diameter 0.7 m

ACCOMMODATION

Comfortable heated and air-conditioned accommodation for 7 persons in two double crew cabins and three single officer cabins. A combined galley and mess with adjacent store and sufficient sanitary facilities are provided. The technical space is fitted below wheelhouse.

NAUTICAL AND COMMUNICATION EQUIPMENT – GMDSS A3

Searchlight	2x Pesch, 2000 W
Radar system	1x Furuno, FAR-1518BB
Magnetic compass	1x Cassens & Plat, Reflecta 1
Autopilot	1x Simrad, AP-70
Gyro compass	1x Simrad, GC-80
GPS	1x Furuno, GP-170D
AIS	1x Sailor, 6280
Echosounder	1x Furuno, FE-800
Speedlog	1x Skipper, EML-224
Intercom	1x Phonetech, CIS3101
Watch alarm	1x Furuno, BR-500
VHF / DSC	2x Cobham, Sailor 7222
Handheld VHF	2x Entel, HT649
SSB	1x Cobham, Sailor 6310
Inmarsat - C	2x Lars Thrane, LT3100S
Navtex	1x Sailor, 6391
Radio / TV aerial	1x Seas systems, SEAS-6000

> Selected makes and types are only to indicate quality of equipment and are not definite.

Multi Cat 3013

STANDARD

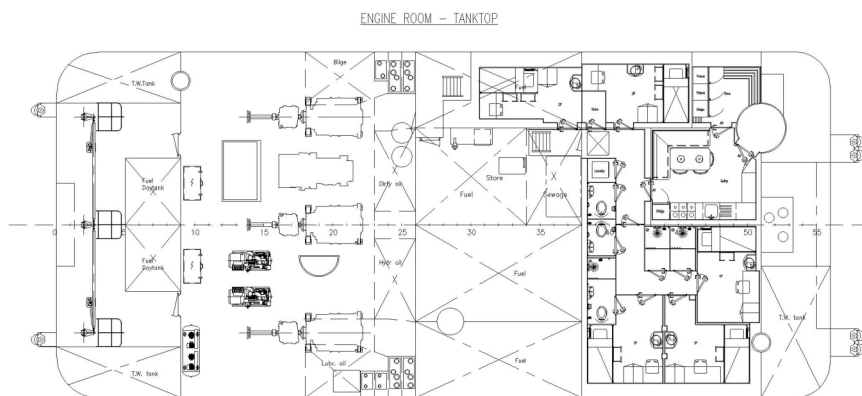
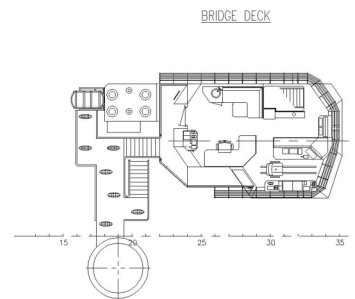
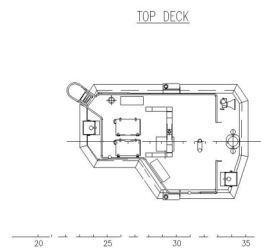
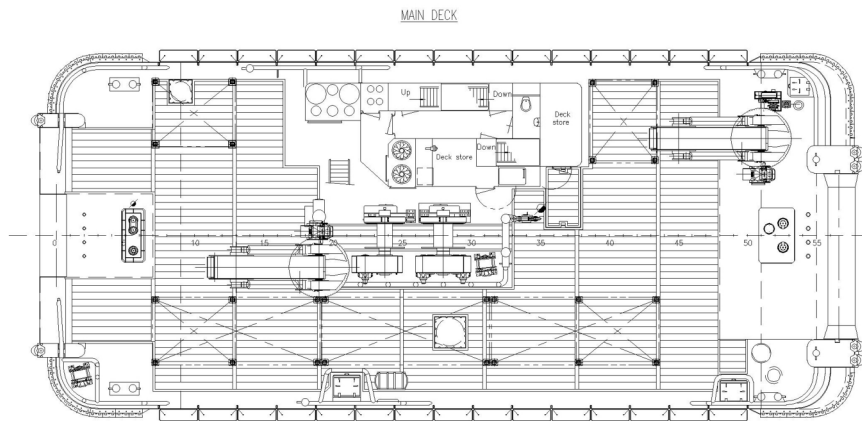
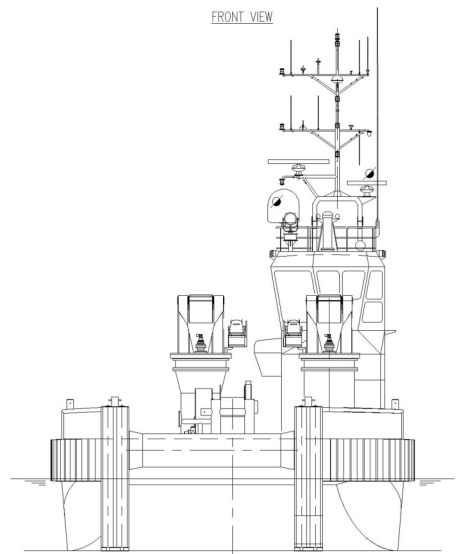
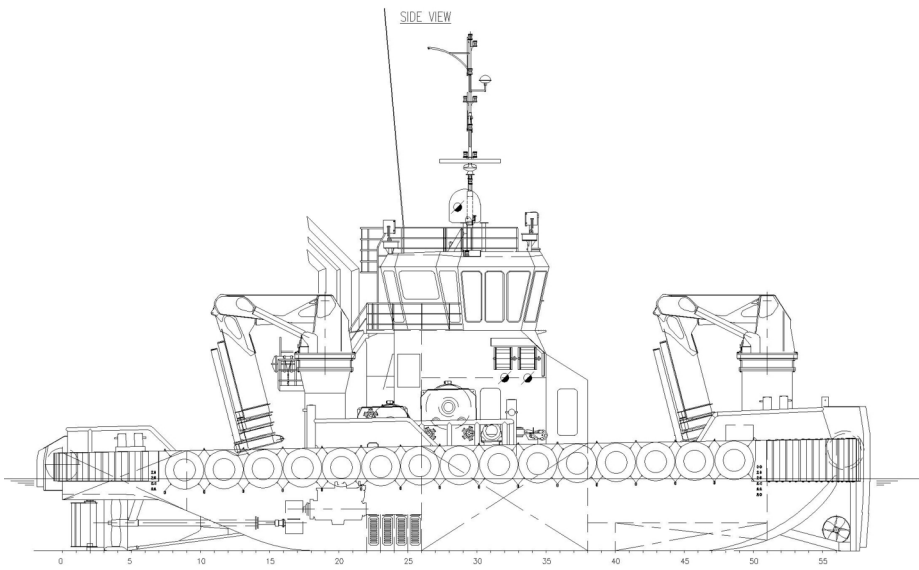

DAMEN

Damen.com

© No part of the leaflet may be reproduced in any form, by print, photoprint, microfilm, or any other means, without written permission from Damen Shipyards Group